

The Tanks

Tate Modern - Level 0

- **Capacities**

- Cabaret: n/a
- Theatre: n/a
- Reception: 900
- Dinner: 400

Drawing Notes:

Do not scale from this drawing,
all measurements should be
confirmed on site.

**FLOOR PLAN Not To Scale @
A3**

**USABLE EVENT SPACE
2,466.2 M² APPROX.**

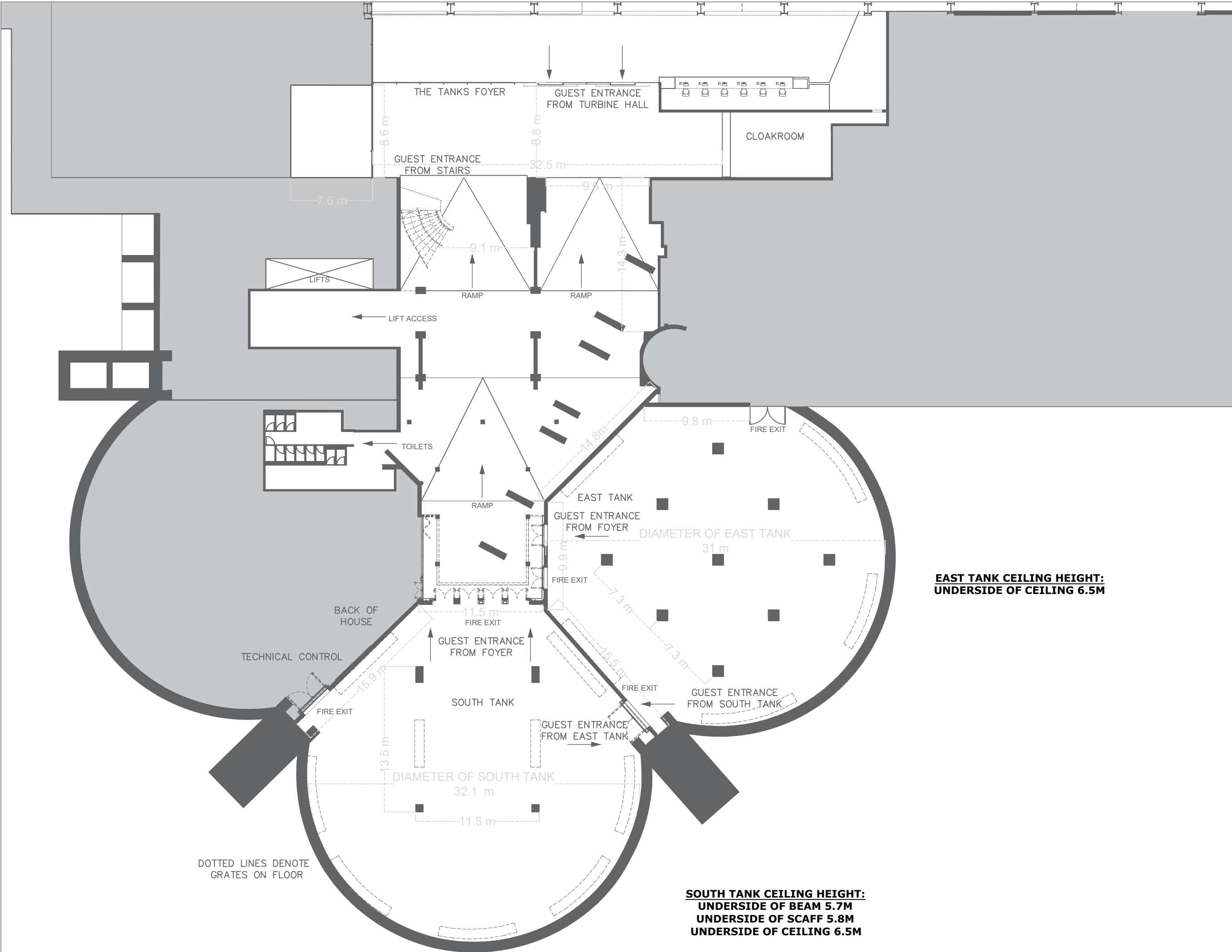

**EAST TANK CEILING HEIGHT:
UNDERSIDE OF CEILING 6.5M**

**SOUTH TANK CEILING HEIGHT:
UNDERSIDE OF BEAM 5.7M
UNDERSIDE OF SCAFF 5.8M
UNDERSIDE OF CEILING 6.5M**